

# FPM Series

## Timer/Controller for Fuel Polishing Module



### Perform Unattended Fuel System Maintenance

This programmable timer/controller enables flexible scheduling of the fuel system maintenance performed by Parker's Fuel Polishing Module. The timer's intuitive operation makes programming the timer quick and easy using push buttons and simple display prompts. In addition, the timer's lithium ion battery provides up to 5 years of life before it requires replacement.

### Features

- **Highly customizable scheduling capability uses up to 56 weekly switching cycles (up to 8 distinct cycles per day)**
- **Manual override feature eliminates the need for an additional helm switch**
- **Splash proof enclosure available in black anodized aluminum or stylish brass finish**
- **Surface- or flush-mountable enclosure for easy installation**

### Programmable Timer Features

- **12 hour and 24 hour display options**
- **8 daily switching cycles**
- **1 minute minimum cycle time**
- **Skip-a-day function to skip over one day's pre-programmed cycles**
- **Manual override switch for manual on/off control**

### Other Applications

Additional programmable timer/controllers (FPM-PTC-12) can also be used to control other devices installed in the onboard DC electrical system. The FPM-PTC-12 can be used to switch any 12 VDC device that draws up to 12 A (at 25 °C or 16 A at 45°C).

- **Anchor Lights—never worry about leaving your lights running all day and draining your batteries**
- **Cabin Lights—for added security and safety when reboarding from tender at night**
- **Powered Ventilation—keep cabin air fresh by automatically circulating fresh air in and stale air out**
- **Fans—save power by turning off fans during the night as the boat cools down**

### Parker Hannifin Corporation Energy Systems

95 Edgewood Avenue  
New Britain, CT 06051

Tel: 877-217-4501  
Fax: 866-781-7426

info@parkerfuelpolishing.com  
www.parkerfuelpolishing.com



# FPM Series Timer/Controller

## Electronic Properties

### Main Power:

Single Pole/Single Throw  
(SPST) Switch

### Switch current ratings:

16 A at 45°C  
10 A at 55°C

### Operating voltage:

12 VDC

### Connections:

18 AWG flying leads

## Diagram

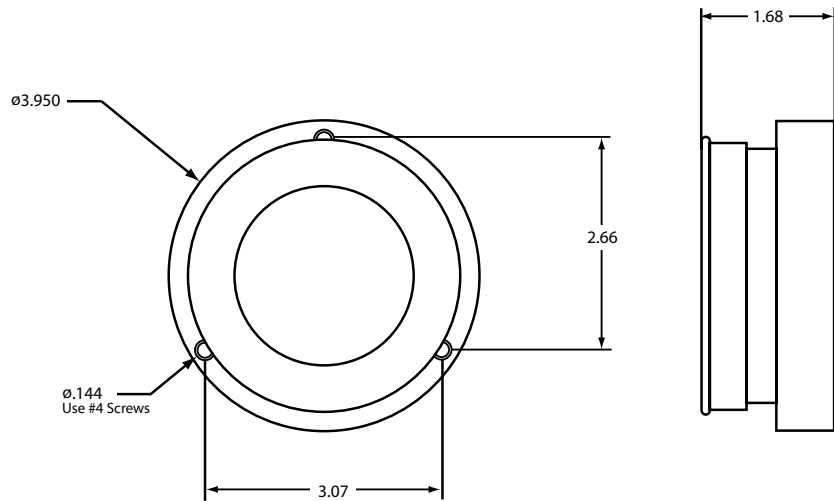

## Mechanical Information

### Operating temperature range:

14°F (-10°C) to 131°F (55°C)

### Overall size:

3.95" diameter x 1.68" deep  
(including cover)

### Weight:

Approximately 0.75 lbs.

### Mounting:

#4 screws are recommended

## Available Part Numbers

Part Number	Description
FPM-PTC-12-A	Timer/Controller with Anodized Aluminum Housing
FPM-PTC-12-B	Timer/Controller with Polished Brass Housing

## Ordering Information

Tel: 877-217-4501

Fax: 866-781-7426

info@parkerfuelpolishing.com

www.parkerfuelpolishing.com



Rev. 02/2009

ENGINEERING YOUR SUCCESS.

